

Setting Up Bitwarden

Just a few steps to get started with Bitwarden.

- [Creating a Bitwarden Account](#)
- [Configuring the Bitwarden Browser Extension](#)

Creating a Bitwarden Account

Introduction

<https://www.youtube.com/embed/W6Miu-TJI1c>

Bitwarden offers account sign-up and a number of price-tiered plans. By hosting an instance of Bitwarden on <https://bitwarden.grey.fail>, our users enjoy the paid version of Bitwarden for free.

All data submitted to <https://bitwarden.grey.fail> is protected with extremely strong encryption based on the master password you select. **Administrators do not have access to your passwords.**

This tutorial will take you from sign-up all the way to creating the first password-entry in your Bitwarden vault.

Note: Open registration on <https://bitwarden.grey.fail> is **disabled** and users must be invited. Once an administrator has invited you, a link is emailed to your email address.

Instructions

Creating Your Account

Joining the Organization

Once you are invited, a link will be e-mailed to the address you provided one of our administrators. Clicking on the link will direct you to a "Join Organization" page. Select "Create Account."

Join Organization

Grey

chris.m.remijan@gmail.com

You've been invited to join the organization listed above. To accept the invitation, you need to log in or create a new Bitwarden account.

[Log In](#)[Create Account](#)

© 2022, Bitwarden Inc. (Powered by Vaultwarden)
Version 2.25.1

Providing Account Details

You will then be prompted with a user form. Please fill out the applicable details. Make sure your master password is something you can remember but is also adequately complex. Do not forget your master password.

The option to enable two-factor-authentication (2FA) will be available once you sign up in your user settings. Enabling 2FA is strongly encouraged for this application.

Note: Only the e-mail address you provided will be allowed in the "Email Address" field. A different e-mail address will fail to submit.

Create Account

Email Address

You'll use your email address to log in.

Your Name

What should we call you?

Master Password



Strong

The master password is the password you use to access your vault. It is very important that you do not forget your master password. There is no way to recover the password in the event that you forget it.

Re-type Master Password



Master Password Hint (optional)

A master password hint can help you remember your password if you forget it.

© 2022, Bitwarden Inc. (Powered by Vaultwarden)
Version 2.25.1

Validating the Associated E-Mail Address

Once you have submitted your user form, an additional e-mail will be sent to you asking to validate your address. Once you have received the message, please click "Verify Email Address Now" (highlighted below).



Thank you for creating an account at <https://bitwarden.grey.fail>. Before you can login with your new account, you must verify this email address by clicking the link below.

Verify Email Address Now

If you did not request to create an account, you can safely ignore this email.



Logging In for the First Time

You will be redirected to a log-in page. Proceed to login using the credentials you created in step 2 (the user form).



Log in or create a new account to access
your secure vault.

Email Address

chris.m.remijan@gmail.com

Master Password

.....



[Get master password hint](#)

☒ Remember email

Log In

Create Account

© 2022, Bitwarden Inc. (Powered by Vaultwarden)
Version 2.25.1

The Bitwarden Dashboard

After successfully logging in, you will be presented with your Bitwarden dashboard. This is one of many ways to interact with your saved passwords, cards, notes, and identities.

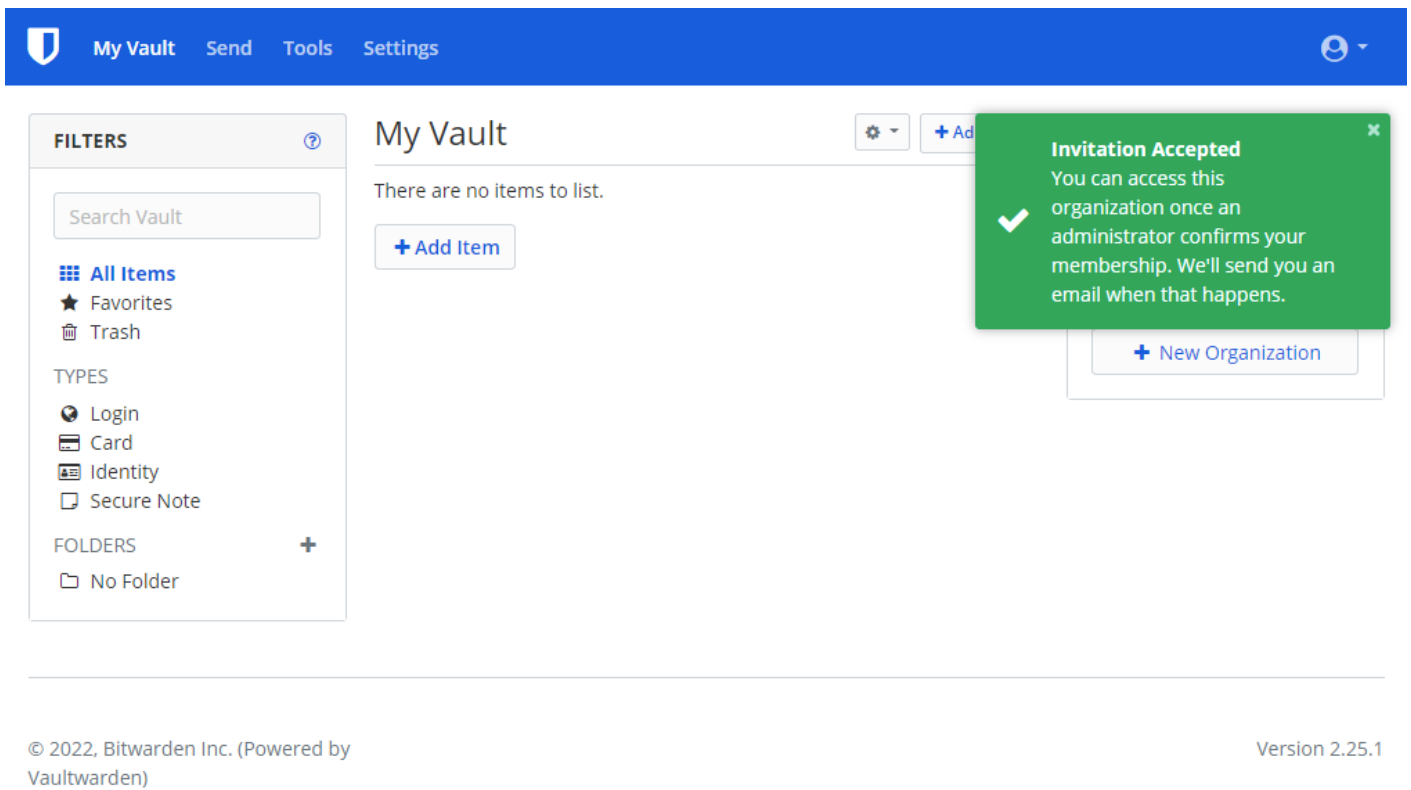

Creating a New Item

Adding a New Item to Your Vault

Adding an item is as easy as selecting the "+ Add Item" button and filling out the entry form.

In order for any browser extension to autofill user credentials, it is important to provide URL data (see "https://cloud.grey.fail" in the example below). This is how the Bitwarden browser extension distinguishes what credentials to apply to the website you are viewing.

My Vault

FILTERS

Search Vault

All Items

Favorites

Trash

TYPES

Login

Card

Identity

Secure Note

FOLDERS

No Folder

© 2022, Bitwarden

Vaultwarden)

ADD ITEM

What type of item is this?

Login

Name

NextCloud

Folder

No Folder

Username

chris

Password

.....

Authenticator Key (TOTP)

10 878 724

URI 1

https://cloud.grey.fail/

Match Detection

Default match detection

+ New URI

Notes

Nextcloud is the best cloud!

CUSTOM FIELDS

+ New Custom Field

Text



OPTIONS

☐ Master password re-prompt

Save

Cancel

Once you save your new item, a new line item will appear in your vault. Feel free to organize line items into folders or types.

 My Vault Send Tools Settings 

FILTERS ?

All Items

Favorites

Trash

TYPES

Login

Card

Identity

Secure Note

FOLDERS +

No Folder

My Vault

 [+ Add Item](#)

☐  NextCloud
chris

ORGANIZATIONS ?

You do not belong to any organizations. Organizations allow you to securely share items with other users.

[+ New Organization](#)

© 2022, Bitwarden Inc. (Powered by Vaultwarden)

Version 2.25.1

Conclusion

Congratulations! You are now using Bitwarden as a password manager! For ease of use, make sure to explore the Bitwarden browser extensions and desktop clients.

Configuring the Bitwarden Browser Extension

Introduction

https://www.youtube.com/embed/J_z4VqERVkQ

The Bitwarden extension is available on all major browsers and allows access to your synchronized password database. The extension also provides autofill, automatic synchronization, built-in and password generation.

Instructions

Note: **As an instance of Bitwarden is hosted on bitwarden.grey.fail, there is the additional step of adding a customized server URL. Please refer to step three.** Steps five and six detail enabling autofill.

Initial Extension Set Up

Install the Bitwarden extension/add-on from the browser extension/add-on store. Once the extension has installed, click on the extension's icon. From there, select the gear icon in the upper left.

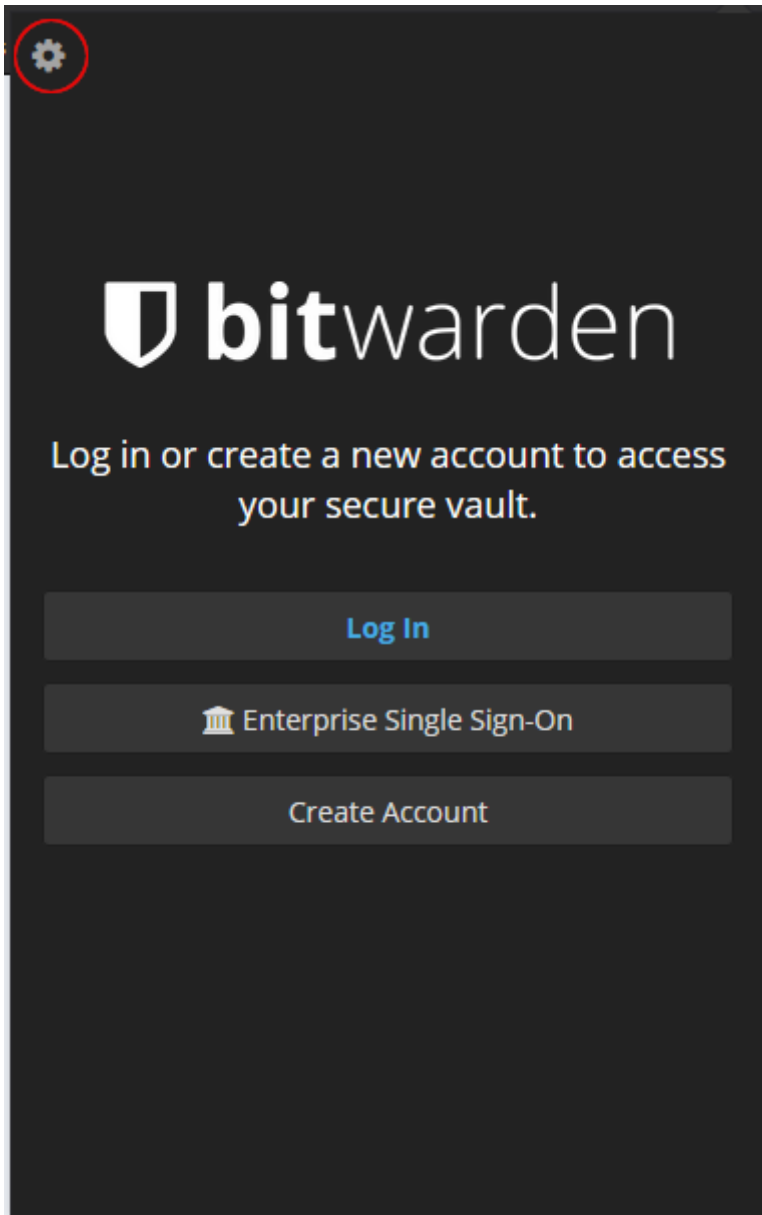

Add the enterprise address to the extension:

<https://bitwarden.grey.fail>

Close Bitwarden Save

SELF-HOSTED ENVIRONMENT

Server URL

https://bitwarden.grey.fail

Specify the base URL of your on-premises hosted Bitwarden installation.

CUSTOM ENVIRONMENT

Web Vault Server URL

API Server URL

Identity Server URL

Notifications Server URL

Icons Server URL

For advanced users. You can specify the base URL of each service independently.

Now you can log in with the account you created at bitwarden.grey.fail.

Enabling Auto-fill

Auto-fill detects log-in prompts on web pages and automatically fills out your saved username and password information. Auto-fill is disabled by default. To turn it on, select "Settings" at the bottom, then select "Options" from the list (at the bottom).

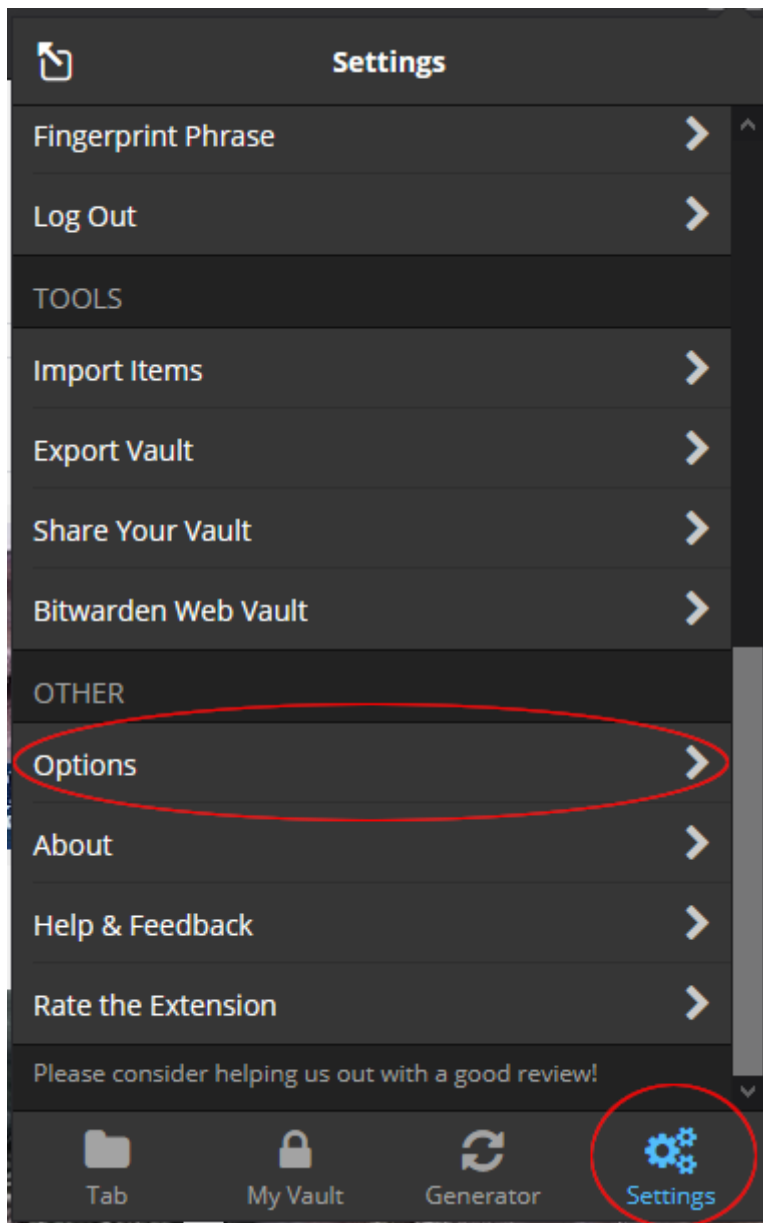

Check "Enable Auto-fill On Page Load."

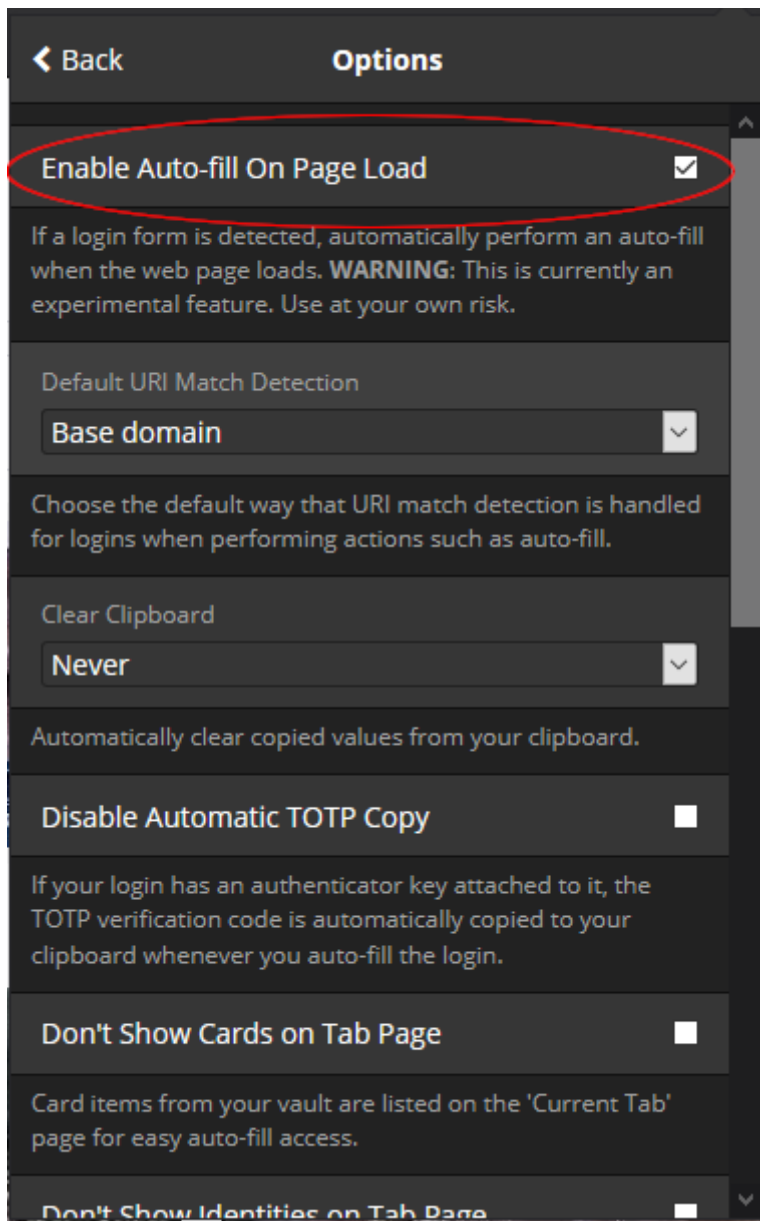

That's it! You're all set up.