

Configuring the Bitwarden Browser Extension

Introduction

https://www.youtube.com/embed/J_z4VqERVkQ

The Bitwarden extension is available on all major browsers and allows access to your synchronized password database. The extension also provides autofill, automatic synchronization, built-in and password generation.

Instructions

Note: **As an instance of Bitwarden is hosted on bitwarden.grey.fail, there is the additional step of adding a customized server URL. Please refer to step three.** Steps five and six detail enabling autofill.

Initial Extension Set Up

Install the Bitwarden extension/add-on from the browser extension/add-on store. Once the extension has installed, click on the extension's icon. From there, select the gear icon in the upper left.

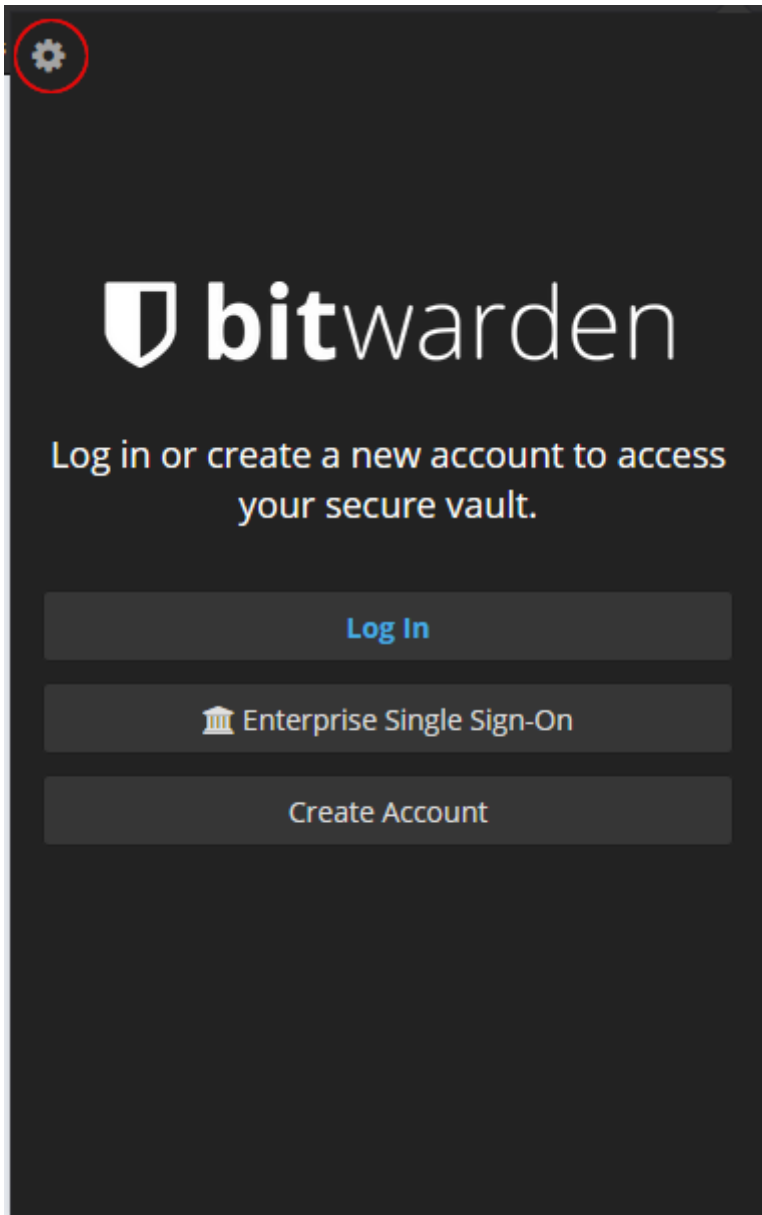

Add the enterprise address to the extension:

<https://bitwarden.grey.fail>

Close Bitwarden Save

SELF-HOSTED ENVIRONMENT

Server URL

https://bitwarden.grey.fail

Specify the base URL of your on-premises hosted Bitwarden installation.

CUSTOM ENVIRONMENT

Web Vault Server URL

API Server URL

Identity Server URL

Notifications Server URL

Icons Server URL

For advanced users. You can specify the base URL of each service independently.

Now you can log in with the account you created at bitwarden.grey.fail.

Enabling Auto-fill

Auto-fill detects log-in prompts on web pages and automatically fills out your saved username and password information. Auto-fill is disabled by default. To turn it on, select "Settings" at the bottom, then select "Options" from the list (at the bottom).

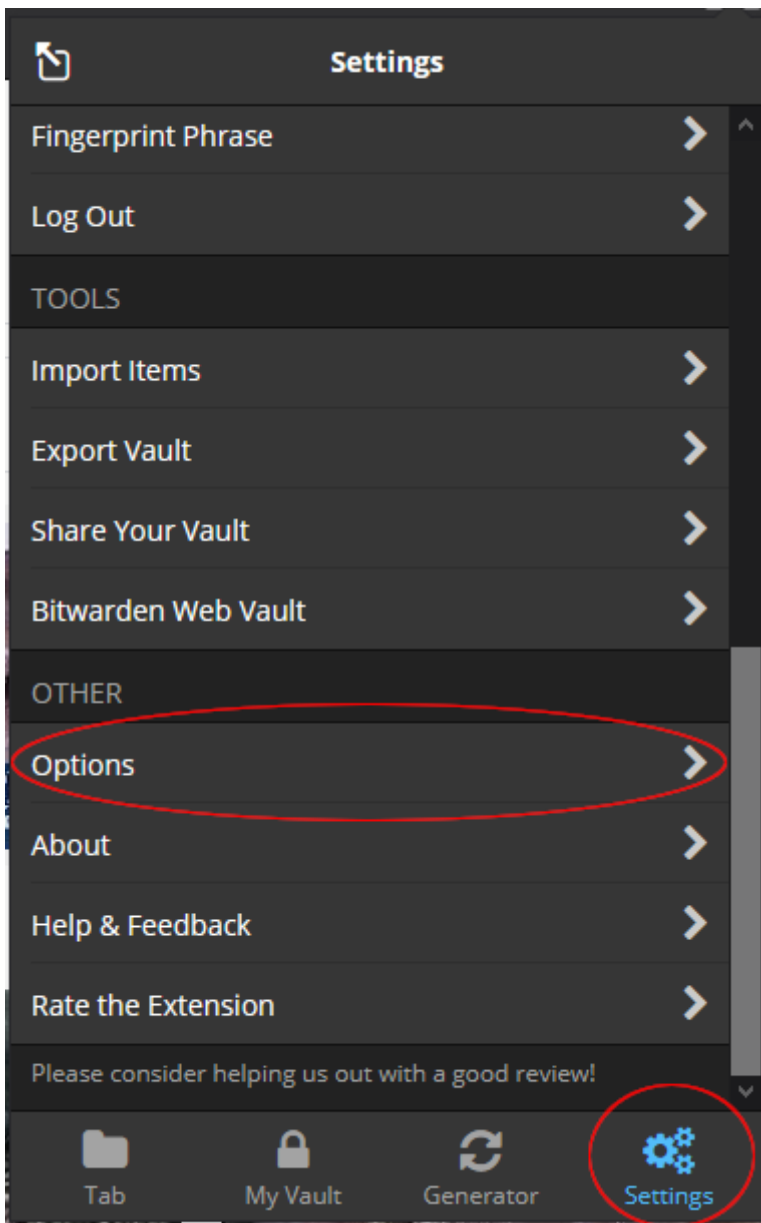

Check "Enable Auto-fill On Page Load."

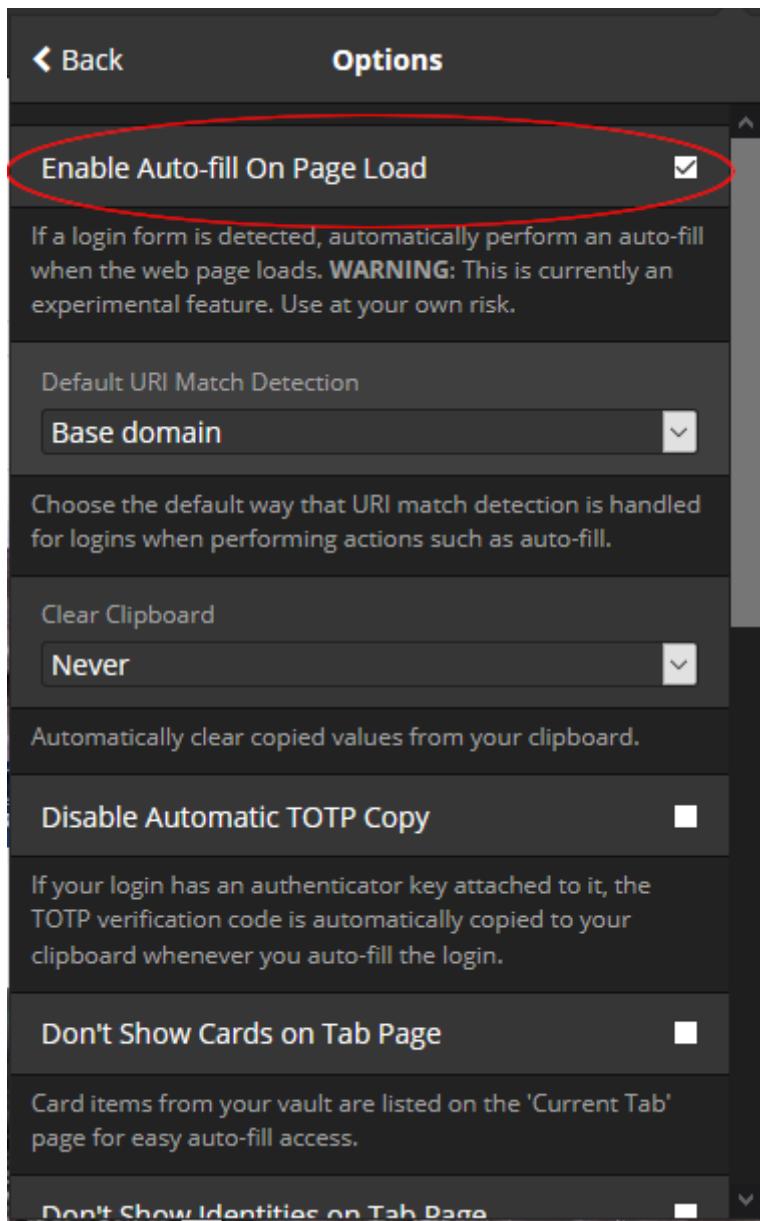

That's it! You're all set up.

Revision #11

Created 13 February 2022 02:39:15 by chris

Updated 1 May 2024 13:15:54 by chris